

- for T-slot profile cylinder
- AC/DC 3-wire
- 39 x 5 x 5 mm

Output	NO
Switching capacity	max. 2 W/VA
Switching voltage	10...30 VDC/AC
Switching current	max. 100 mA
Switching on time	0,5 ms
Switching off time	0,3 ms
Operating temperature	-25 °C...+70 °C
Switching distance sn	Depending on a magnetic field

Dielectric test voltage ac (rms.) Ui	--- V
Protection class to DIN 60 529	IP 67
On/Off indication	LED
Connection	2,5 m PCV-cable Plug with thread M8x1 with knurled nut
Housing material	Plastic

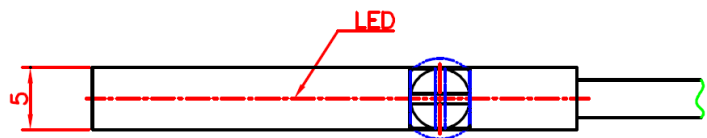
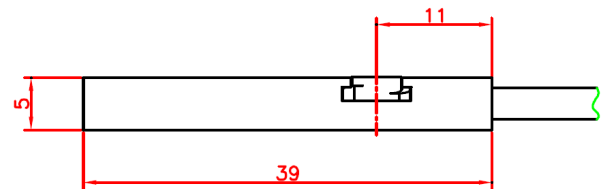
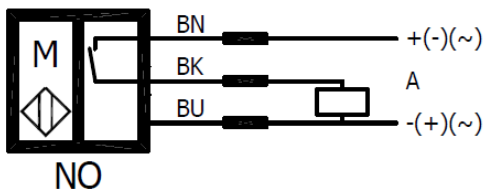

Applications, where personal safety depends on the function of the devices are not authorized by the manufacturer. Technical modifications and errors excepted.